

Radial-Gelenklager GE...-LO, offen

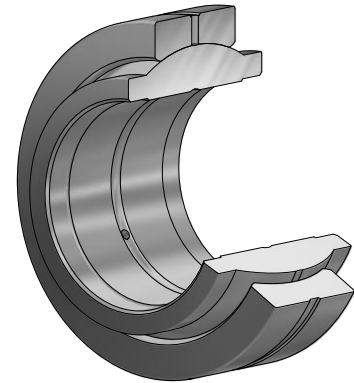



















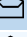
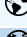

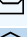

wartungspflichtig
 zylindrische Ansätze am Innenring
 DIN ISO 12 240-1-Maßreihe W
 Gleitpaarung: Stahl/Stahl

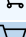

Baureihe: GE...-LO

GE...-LO

Maßtabelle - Abmessungen in mm

Wellen- durch- messer	Kurzzzeichen	Abmessungen				
		d	D	B	C	dk
12	GE12-LO ²⁾⁴⁾   	12 ^{0,018}	22 ^{-0,009}	12 ^{-0,18}	7 ^{-0,24}	18
16	GE16-LO ⁴⁾⁵⁾   	16 ^{0,018}	28 ^{-0,009}	16 ^{-0,18}	9 ^{-0,24}	23
20	GE20-LO ⁵⁾   	20 ^{0,021}	35 ^{-0,011}	20 ^{-0,21}	12 ^{-0,24}	29
25	GE25-LO   	25 ^{0,021}	42 ^{-0,011}	25 ^{-0,21}	16 ^{-0,24}	36
32	GE32-LO   	32 ^{0,025}	52 ^{-0,013}	32 ^{-0,25}	18 ^{-0,30}	44
40	GE40-LO   	40 ^{0,025}	62 ^{-0,013}	40 ^{-0,25}	22 ^{-0,30}	53
50	GE50-LO   	50 ^{0,025}	75 ^{-0,013}	50 ^{-0,25}	28 ^{-0,30}	66
63	GE63-LO   	63 ^{0,030}	95 ^{-0,015}	63 ^{-0,30}	36 ^{-0,40}	83
70	GE70-LO ³⁾   	70 ^{0,030}	105 ^{-0,015}	70 ^{-0,30}	40 ^{-0,40}	92

-
- 1) Bohrungstoleranz: H7 (arithm. Mittelwert).
 - 2) Nicht nachschmierbar.
 - 3) Nicht in DIN ISO 12 240-1-Maßreihe W enthalten.
 - 4) Durchgehend zylindrisch.
 - 5) Innenringkugel ohne Schmierut.
 - 6) Auch in den Gruppen C2 und C3 lieferbar.

Radial-Gelenklager GE...-LO, offen

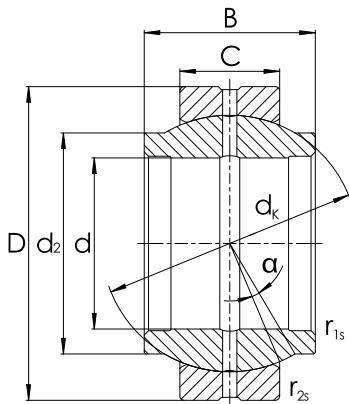

GE...-LO

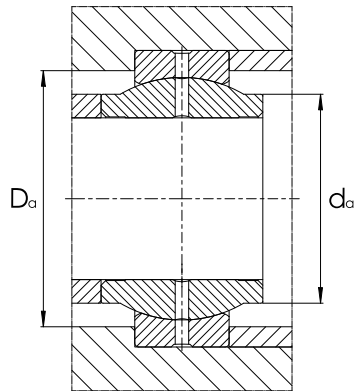

Anschlussmaße

$d_2 = d_{a \max}$	α	Kantenabstände		Anschlussmaße	Tragzahlen		Radiale Lagerluft ⁴⁾	Gewicht	Wellen- durchmesser
		r_{1s}	r_{2s}		D_a	dyn. C_r			
	Grad	min.	min.	min.	kN	kN		≈ kg	d
15,5	4,0	0,3	0,3	17,5	10,8	54	0,032 – 0,070	0,017	12
20,0	4,0	0,3	0,3	23,0	17,6	88	0,040 – 0,082	0,035	16
25,0	4,0	0,3	0,3	27,5	30,0	146	0,040 – 0,082	0,067	20
30,0	4,0	0,6	0,6	33,0	48,0	240	0,050 – 0,100	0,120	25
38,0	4,0	0,6	1,0	42,0	67,0	335	0,050 – 0,100	0,210	32
46,0	4,0	0,6	1,0	51,0	100,0	500	0,060 – 0,120	0,330	40
57,0	4,0	0,6	1,0	63,0	156,0	780	0,060 – 0,120	0,590	50
71,5	4,0	1,0	1,0	78,0	255,0	1.270	0,072 – 0,142	1,300	63
79,0	4,0	1,0	1,0	87,0	315,0	1.560	0,072 – 0,142	1,600	70