

Radial-Gelenklager GE...-FO, offen

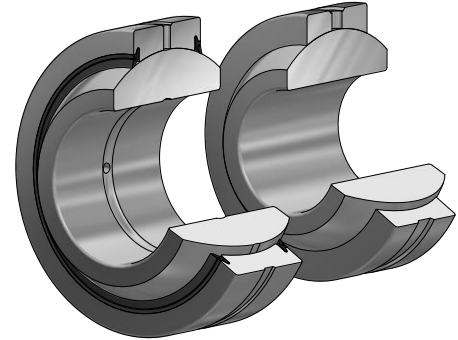











wartungspflichtig
 DIN ISO 12 240-1-Maßreihe G
 Gleitpaarung: Stahl/Stahl



Baureihe: GE...-FO

GE...-FO, GE...-FO-2RS

Maßtabelle - Abmessungen in mm

Wellen- durch- messer	Kurzzeichen ohne Abdichtung	Abmessungen						
		d	D	B	C	d _k	α	
d								Grad
6	GE6-FO ¹⁾   	6 ^{-0,008}	16 ^{-0,008}	9 ^{-0,12}	5 ^{-0,24}	13 ³⁾	21	
8	GE8-FO ¹⁾   	8 ^{-0,008}	19 ^{-0,009}	11 ^{-0,12}	6 ^{-0,24}	16 ³⁾	21	
10	GE10-FO ¹⁾   	10 ^{-0,008}	22 ^{-0,009}	12 ^{-0,12}	7 ^{-0,24}	18 ³⁾	18	
12	GE12-FO ²⁾   	12 ^{-0,008}	26 ^{-0,009}	15 ^{-0,12}	9 ^{-0,24}	22 ³⁾	18	

-
- 1) Nicht nachschmierbar.
 - 2) Nur über den Außenring nachschmierbar.
 - 3) Keine Schmiernut auf der Innenringkugel.
 - 4) Auch in den Gruppen C2 und C3 lieferbar.

Radial-Gelenklager GE...-FO, offen

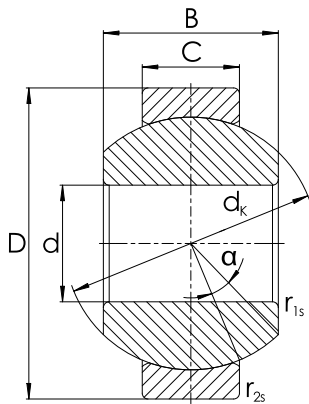

GE...-FO

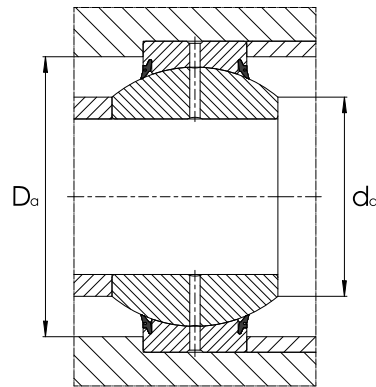

Anschlussmaße

Kantenabstände		Anschlussmaße		Tragzahlen		Radiale Lagerluft ⁴⁾	Gewicht ≈ kg	Wellen- durchmesser d
r _{1s} min.	r _{2s} min.	d _a max.	D _a min.	dyn. C _r kN	stat. C _{0r} kN			
0,3	0,3	9,3	12,5	5,50	27,5	0,032 – 0,068	0,008	6
0,3	0,3	11,6	15,5	8,15	40,5	0,032 – 0,068	0,014	8
0,3	0,3	13,4	17,5	10,80	54,0	0,032 – 0,068	0,020	10
0,3	0,3	16,0	21,0	17,00	85,0	0,040 – 0,082	0,034	12

Radial-Gelenklager GE...-FO-2RS, beidseitig abgedichtet

wartungspflichtig

DIN ISO 12 240-1-Maßreihe G



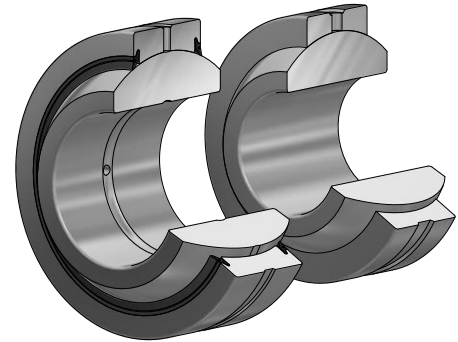





























Gleitpaarung: Stahl/Stahl



Baureihe: GE...-FO-2RS

GE...-FO, GE...-FO-2RS

Maßtabelle - Abmessungen in mm

Wellen- durch- messer	Kurzzeichen mit Abdichtung	Abmessungen					
		d	D	B	C	dk	α Grad
15	GE15-FO-2RS   	15 _{-0,008}	30 _{-0,009}	16 _{-0,12}	10 _{-0,24}	25 ³⁾	16
17	GE17-FO-2RS   	17 _{-0,008}	35 _{-0,011}	20 _{-0,12}	12 _{-0,24}	29 ³⁾	19
20	GE20-FO-2RS   	20 _{-0,010}	42 _{-0,011}	25 _{-0,12}	16 _{-0,24}	36	17
25	GE25-FO-2RS   	25 _{-0,010}	47 _{-0,011}	28 _{-0,12}	18 _{-0,24}	41	17
30	GE30-FO-2RS   	30 _{-0,010}	55 _{-0,013}	32 _{-0,12}	20 _{-0,30}	47	17
35	GE35-FO-2RS   	35 _{-0,012}	62 _{-0,013}	35 _{-0,12}	22 _{-0,30}	53	16
40	GE40-FO-2RS   	40 _{-0,012}	68 _{-0,013}	40 _{-0,12}	25 _{-0,30}	60	17
45	GE45-FO-2RS   	45 _{-0,012}	75 _{-0,013}	43 _{-0,12}	28 _{-0,30}	66	15
50	GE50-FO-2RS   	50 _{-0,012}	90 _{-0,015}	56 _{-0,15}	36 _{-0,40}	80	17
60	GE60-FO-2RS   	60 _{-0,015}	105 _{-0,015}	63 _{-0,15}	40 _{-0,40}	92	17
70	GE70-FO-2RS   	70 _{-0,015}	120 _{-0,015}	70 _{-0,15}	45 _{-0,40}	105	16

-
- 1) Nicht nachschmierbar.
 - 2) Nur über den Außenring nachschmierbar.
 - 3) Keine Schmiernut auf der Innenringkugel.
 - 4) Auch in den Gruppen C2 und C3 lieferbar.

Radial-Gelenklager GE...-FO-2RS, beidseitig abgedichtet

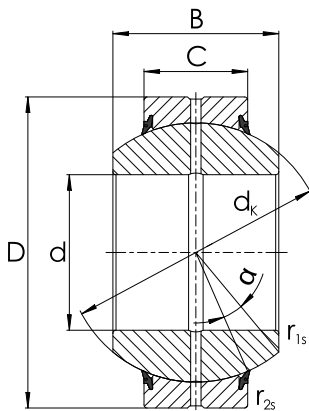

GE...-FO-2RS

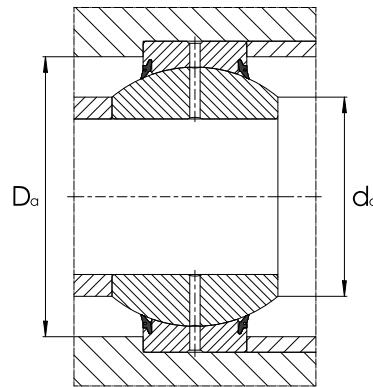

Anschlussmaße

Kantenabstände		Anschlussmaße		Tragzahlen		Radiale Lagerluft ⁴⁾	Gewicht ≈ kg	Wellen- durchmesser d
r_{1s} min.	r_{2s} min.	d_a max.	D_a min.	dyn. C_r kN	stat. C_{0r} kN			
0,3	0,3	19,2	24,0	21,2	106	0,040 – 0,082	0,046	15
0,3	0,3	21,0	27,5	30,0	146	0,040 – 0,082	0,077	17
0,3	0,6	25,2	33,0	48,0	240	0,050 – 0,100	0,150	20
0,6	0,6	29,5	38,0	62,0	310	0,050 – 0,100	0,190	25
0,6	1,0	34,4	44,5	80,0	400	0,050 – 0,100	0,290	30
0,6	1,0	39,7	51,0	100,0	500	0,060 – 0,120	0,380	35
0,6	1,0	44,7	57,0	127,0	640	0,060 – 0,120	0,540	40
0,6	1,0	50,0	63,0	156,0	780	0,060 – 0,120	0,680	45
0,6	1,0	57,1	75,0	245,0	1.220	0,060 – 0,120	1,400	50
1,0	1,0	67,0	87,0	315,0	1.560	0,072 – 0,142	2,000	60
1,0	1,0	78,2	99,0	400,0	2.000	0,072 – 0,142	2,900	70

Radial-Gelenklager GE...-FO-2RS, beidseitig abgedichtet

wartungspflichtig

DIN ISO 12 240-1-Maßreihe G



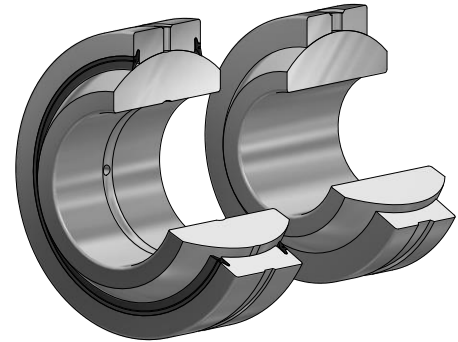

















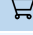
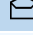

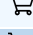
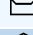





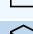

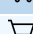
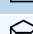

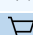
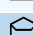

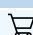
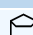
Gleitpaarung: Stahl/Stahl



Baureihe: GE...-FO-2RS

GE...-FO, GE...-FO-2RS

Maßtabelle - Abmessungen in mm

Wellen- durch- messer	Kurzzzeichen mit Abdichtung	Abmessungen					
		d	D	B	C	dk	α
d							Grad
80	GE80-FO-2RS   	80 -0,015	130 -0,018	75 -0,20	50 -0,50	115	14
90	GE90-FO-2RS   	90 -0,020	150 -0,018	85 -0,20	55 -0,50	130	15
100	GE100-FO-2RS   	100 -0,020	160 -0,025	85 -0,20	55 -0,50	140	14
110	GE110-FO-2RS   	110 -0,020	180 -0,025	100 -0,20	70 -0,50	160	12
120	GE120-FO-2RS   	120 -0,020	210 -0,030	115 -0,25	70 -0,60	180	16
140	GE140-FO-2RS   	140 -0,025	230 -0,030	130 -0,25	80 -0,60	200	16
160	GE160-FO-2RS   	160 -0,025	260 -0,035	135 -0,25	80 -0,70	225	16
180	GE180-FO-2RS   	180 -0,025	290 -0,035	155 -0,30	100 -0,70	250	14
200	GE200-FO-2RS   	200 -0,030	320 -0,040	165 -0,30	100 -0,80	275	15
220	GE220-FO-2RS   	220 -0,030	340 -0,040	175 -0,30	100 -0,80	300	16
240	GE240-FO-2RS   	240 -0,030	370 -0,040	190 -0,35	110 -0,80	325	15
260	GE260-FO-2RS   	260 -0,035	400 -0,040	205 -0,35	120 -0,80	350	15
280	GE280-FO-2RS   	280 -0,035	430 -0,045	210 -0,35	120 -0,90	375	15

-
- 1) Nicht nachschmierbar.
 - 2) Nur über den Außenring nachschmierbar.
 - 3) Keine Schmiernut auf der Innenringkugel.
 - 4) Auch in den Gruppen C2 und C3 lieferbar.

Radial-Gelenklager GE...-FO-2RS, beidseitig abgedichtet

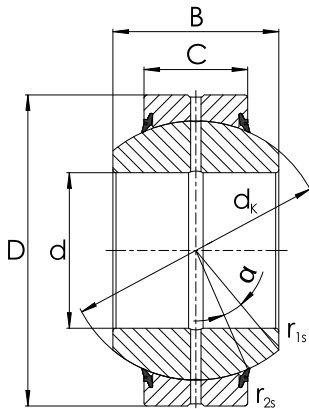

GE...-FO-2RS

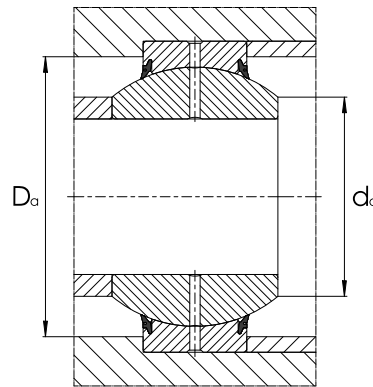

Anschlussmaße

Kantenabstände		Anschlussmaße		Tragzahlen		Radiale Lagerluft ⁴⁾	Gewicht ≈ kg	Wellen- durchmesser d
r _{1s} min.	r _{2s} min.	d _a max.	D _a min.	dyn. C _r kN	stat. C _{0r} kN			
1,0	1,0	87,1	108	490	2.450	0,072 – 0,142	3,5	80
1,0	1,0	98,3	123	610	3.050	0,085 – 0,165	5,4	90
1,0	1,0	111,2	134	655	3.250	0,085 – 0,165	5,9	100
1,0	1,0	124,8	150	950	4.750	0,085 – 0,165	9,6	110
1,0	1,0	138,4	173	1.080	5.400	0,085 – 0,165	15,1	120
1,0	1,0	151,9	191	1.370	6.800	0,100 – 0,192	18,8	140
1,0	1,1	180,0	219	1.530	7.650	0,100 – 0,192	24,7	160
1,1	1,1	196,1	239	2.120	10.600	0,100 – 0,192	35,4	180
1,1	1,1	220,0	267	2.320	11.600	0,110 – 0,214	44,8	200
1,1	1,1	243,6	295	2.550	12.700	0,110 – 0,214	50,9	220
1,1	1,1	263,6	319	3.050	15.300	0,125 – 0,239	64,9	240
1,1	1,1	283,6	342	3.550	18.000	0,125 – 0,239	81,7	260
1,1	1,1	310,6	370	3.800	19.000	0,125 – 0,239	96,5	280